

CORRECTION RATIO					
MODEL	# OF TURNS CORR. SHAFT	EFFECT DN 1 RPM SHAFT	# OF DEG./TURN	EFFECT DN 2 RPM SHAFT	# OF DEG./TURN
ILD1-1 20:1 RATIO	20	180 DEG.	9 DEG.	360 DEG.	18 DEG.
ILD1-1 40:1 RATIO	20	90 DEG.	4 1/2 DEG.	180 DEG.	9 DEG.

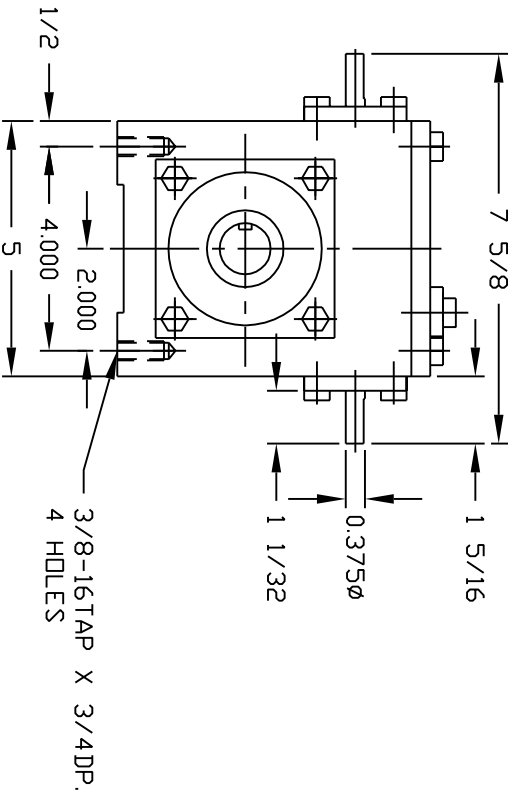
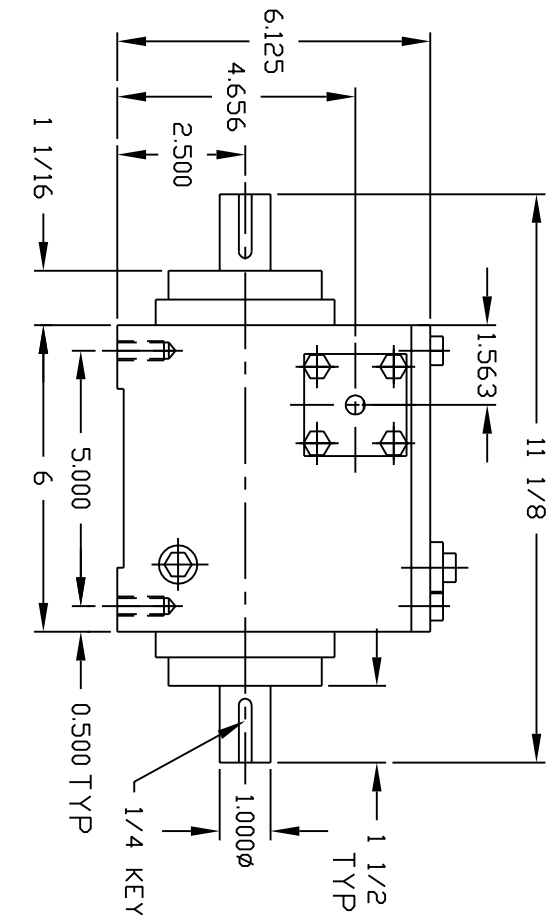
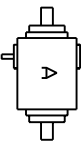
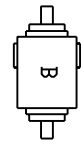
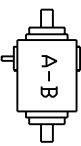

- NOTES:
1. MAIN SHAFTS ROTATE 2:1 IN SAME DIRECTION INPUT TO EITHER SHAFT-CLOCKWISE OR COUNTER CLOCKWISE
 2. HORSEPOWER - 1.6 H.P. @ 300 RPM @ INPUT HIGH SPEED SHAFT, MAX. SPEED - 600 RPM.
 3. CONTROL SHAFT CAN BE MOTORIZED FOR REMOTE OPERATION
 4. LUBRICATION: 1 PINT - MOBIL GEAR # 629
 5. WEIGHT : 19 LBS. / 24 LBS. W/MOTOR.

TYPES OF MANUAL CONTROL LOCATION		
A EXTENDED	B EXTENDED	DOUBLE EXTENDED
		

FMP

SCALE: 1:4

TITLE: IN-LINE DIFFERENTIAL ILDT-2

REV:

TOL EXCEPT AS NOTED

CAD#

FINISH:

DRAWN: D.K.

+/- .005

+/- 1/64

+/- 1/2

DATE: 1/26/07

MAT'L:

DR# D-208B

APR: